



GARAGE EXHAUST SYSTEMS: HOSE AND ACCESSORIES

Application: Garage exhaust hose and accessories are designed for both floor and overhead use in both small car and heavy-duty truck garages. Garage exhaust hose is designed to connect to the tailpipe and provide easy escape of the vehicle exhaust gas.

Construction

Temperature Range F & C: Up to +600°F (+316°C)

Seven easy steps to developing a complete garage exhaust system:

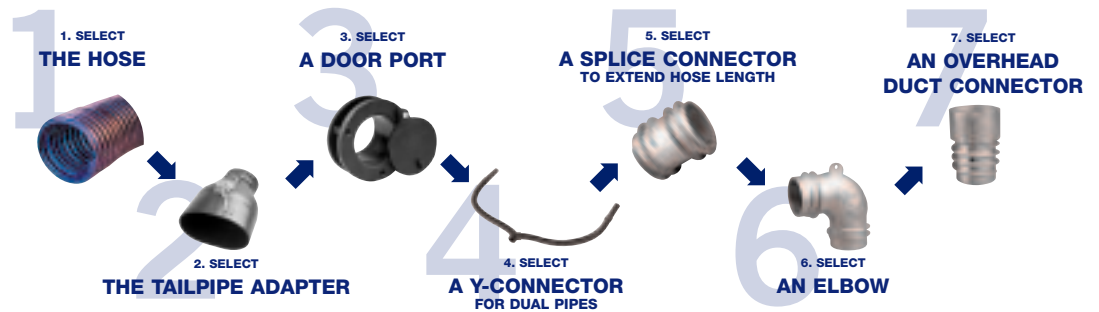

ORDER GUIDE

Develop Garage Exhaust Systems using compatible parts

Rubber Hose	ID(in.) x Length(ft.)	Tailpipe Adapter	Door Port	Y-Connector	Splice Connector	Elbows	Overhead Duct Connector
FLT 200	2 x 11	F250 Straight RA300 Bell	DF25 Rubber	RY20 Rubber	SP20	EB20	NA
FLT 250	2 1/2 x 11	F250 Straight F300 Straight RA250 Bell	DF25 Rubber	RY25 Rubber	SP25 Rubber	EB25 Rubber AEL25 Aluminum	NA
FLT 300	3 x 11	F250 Straight F300 Straight F350 Straight F475 3 x 6 Oval F575 3 1/2 x 8 1/2 Oval RA300 Bell	ADF30 Aluminum	RY30 Rubber	SP30 Rubber AC30 Aluminum	EP30 Rubber AEL30 Aluminum	OC30 Aluminum
FLT400	4 x 11	F350 Straight F400 Straight DSR600 Straight F475 3 x 6 Oval F575 3 1/2 x 8 1/2 Oval F800 Straight	ADF40 Aluminum	AY40 Aluminum	SP40 Rubber AC40 Aluminum	AEL40 Aluminum	OC40 Aluminum
ACT400	4 x 11	F350 Straight F400 Straight DSR600 Straight F475 3 x 6 Oval F575 3 1/2 x 8 1/2 Oval F800 Straight	ADF40 Aluminum	AY40 Aluminum	SP40 Rubber AC40 Aluminum	AEL40 Aluminum	OC40 Aluminum
ACT500 ACT500w	5 x 11	DSR600 Straight DSR8600 Straight	NA	NA	AC50 Aluminum	AEL50 Aluminum	OC50 Aluminum OC50D AU w/damper
ACT600 ACT600w	6 x 11	DSR600-6 Straight DSR8600 Straight DSR9600 Straight	NA	NA	AC60-OC Aluminum	AEL60 Aluminum	AC60-OC Aluminum

08GRPR066-A
9/05/08

Rubber Hose:

(*) Indicates one flared end per length, allowing connections of two or more length of the same ID. ACT Hose is designed for use with larger gas vehicles and diesel trucks. Also available with wire insert (w). Always use the appropriate tailpipe adapter.

Part Number	Inside (in.)	Diameter Length(ft.)	Intended Application
54032/FLT200*	2	11	Compact Car
54040/FLT250*	2 1/2	11	Compact Car
54048/FLT300*	3	11	Passenger Car
54064/FLT400*	4	11	Gas Truck
ACT400	4	11	Diesel Truck
ACT400 Dyno	4	11	Dyno
ACT500	5	11	Diesel Truck
ACT500w	5	11	Diesel Truck
ACT600	6	11	Diesel Truck
ACT600w	6	11	Diesel Truck



Y-Assemblies:

Designed for dual exhaust vehicles. Includes Hose, Y Connector and Tailpipe Adapter.

Assembly Part Number	Hose ID(in.) x Length(ft.)	Y-Connector	Tailpipe Adapter
YA250	2 ea 2 1/2 x 4	RY25	2 ea F250
YA300	2 ea 3 x 4	RY30	2 ea F300
YA575	2 ea 3 x 4	RY30	2 ea F575
YA400	2 ea 4 x 4	AY40	2 ea F350



Tailpipe Adapters:

Connects hose to various types of tailpipes. Hook and Chain holds adapter in place. Adapters are designed with a 1/2" diameter clearance around the tailpipe.

Part Number	Adapter Description	Hose ID(in) Options	Tailpipe Style	Tail Pipe Size(in.)
F250	Straight with hook and chain	2, 2 1/2, 3	Single	Up to 2"
F300	Straight with hook and chain	2 1/2, 3, 3 1/2	Single	Up to 2 1/2"
F350	Straight with hook and chain	3 1/2, 4	Single	Up to 3"
F350 Dyno	Straight with hook and chain	3 1/2	Single	Up to 3"
F400	Straight with hook and chain	3 1/2, 4	Single	Up to 3 1/2"
F475	Oval (3" x 6")	3, 4	Twin up to 2"	Oval 2 1/2" x 5 1/2"
F475 Dyno	Oval (3" x 6")	3, 4	Twin up to 2"	Oval 2 1/2" x 5 1/2"
F575	Oval (3 1/2" x 8 1/2")	3, 4	Twin up to 3"	Oval 3" x 8"
DSR600	Stack Adapter	4, 5	Diesel Stack	Up to 5 1/2"
DSR600-6	Stack Adapter	6	Diesel Stack	Up to 5 1/2"
F800	Stack Adapter	4	Diesel Stack	Up to 7 1/2"
DSR8600	Stack Adapter	5, 6	Diesel Stack	Up to 7 1/2"
DSR9600	Stack Adapter	6	Diesel Stack	Up to 8 1/2"
RA250	Bell	2 1/2, 3 1/2	All	All
RA300	Bell	2, 3	All	All





Door Ports:

Allows hose to be vented through 1" door

Part Number	Hose ID(in.)	Material
DF25	2 1/2	Rubber
ADF30	3	Aluminum
ADF40	4	Aluminum



DF25

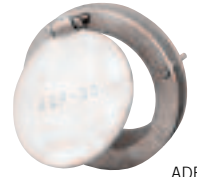

ADF30
ADF40

Y Fittings:

Allows for three hoses to be joined together

Part Number	Hose ID(in.)	Material
RY20	2	Rubber
RY25	2 1/2	Rubber
RY30	3	Rubber
AY40	4	Aluminum



RY20
RY25
RY30



AY40

Splice Connectors:

Joins two hoses together. Internal threads on rubber connector and external threads on metal connector.

Part Number	Hose ID(in.)	Material
SP20	2	Rubber
SP25	2 1/2	Rubber
SP30	3	Rubber
SP40	4	Rubber
AC30	3	Aluminum
AC40	4	Aluminum
AC50	5	Aluminum
AC60-OC	6	Aluminum



SP20
SP25
SP30
SP40

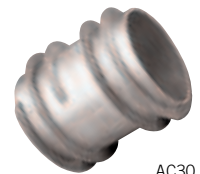

AC30
AC40
AC50
AC60-OC

Elbows:

Rubber elbows connect to underfloor exhaust systems. Aluminum elbows connect two hoses in an overhead pulley system.

Part Number	Hose ID(in.)	Material
EB20	2	Rubber
EB25	2 1/2	Rubber
EB30	3	Rubber
AEL25	2 1/2	Aluminum
AEL30	3	Aluminum
AEL40	4	Aluminum
AEL50	5	Aluminum
AEL60	6	Aluminum



EB20
EB25
EB30



AEL25
AEL30
AEL40
AEL50
AEL60

Overhead Duct Connectors:

Adapter to Overhead T's

Part Number	Duct size	Material
OC30	3	Aluminum
OC40	4	Aluminum
OC50	5	Aluminum
OC50D	5 with Damper	Aluminum
AC60-OC	6	Aluminum

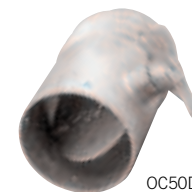

OC50D



OC30
OC40
OC50
AC60-OC

The GOODYEAR (and Winged Foot Design) trademark is used by Veyance Technologies, Inc. under license from The Goodyear Tire & Rubber Company. Goodyear Engineered Products are manufactured and sourced exclusively by Veyance Technologies, Inc. or its affiliates. ©2008 Veyance Technologies, Inc. All Rights Reserved.